



KIT ADMISSION DIRECTE **DIRECT INDUCTION KIT**

PEUGEOT 306 XS
1.6L Multipoint injection

S.A.S.

Chrono'Sport

122 rue du faubourg Saint Jean
ZA de l'AVELON - 60000 BEAUVAIS -
FRANCE



00.33.3.44.02.64.64



00.33.3.44.02.87.10

Part n° :P153

FITTING INSTRUCTION

- Remove the complete air box.
- Remove the air temperature probe from the air box and screw it back in the hole on the kit using the hole nearest the filter element.
- Remove the flexible pipe which links the cylinder head cover to the air box.
- Fix the small GREEN filter to the pipe of the cylinder head cover.
- Fix the GREEN kit to the throttle box, CAUTION : remove all the sealant from the throttle box.
- Reconnect the negative pressure pipe to the small connector on the lower part of the kit.

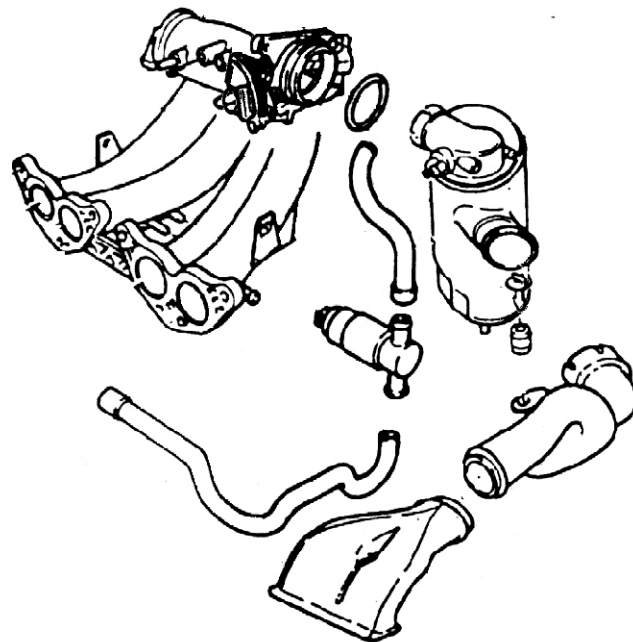
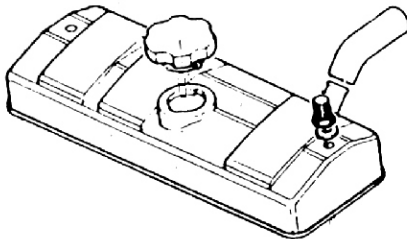

IMPORTANT:

The running of your engine is linked directly with the maintenance of the air filter. Clean your air filter every 7000 kms or 4500 miles with Green cleaning products..

WARRANTY:

The air filter guarantee is for defects in materials and workmanship only. Guarantee is void if the air filter is damaged by an accident, unreasonable use, neglect, misuse, abuse, improper installation or other causes not arising out of defects in materials and workmanship. The induction kit is a technical product so it is necessary to have some basic mechanical skills. If problems do not hesitate to have your induction kit fitted by a professional.

Green Technical dept : TEL: 00.33.3.44.02.64.64