



KIT ADMISSION DIRECTE DIRECT INDUCTION KIT

CITROEN XANTIA 2L HDI 110HP

S.A.S

Chrono'Sport

122 rue du faubourg Saint Jean
ZA de l'AVELON - 60000 BEAUVAIS -
FRANCE

 00.33.3.44.02.64.64

 00.33.3.44.02.87.10

Part n° :P387

FITTING INSTRUCTION

Remove the upper part of the air box.(see diagram A)

Disconnect the air flow meter from the upper part of the air box.

Fix the air flow meter onto the pipe A (see diagram B)

Fix the green filter with the attaching bracket onto the air flow meter then adjust it so that it does not touch a mechanical part.(see diagram B)

Drill the lower part of the air box with a hole of diameter 8.5 then fix the filter with the screw provided.
(See diagram B)

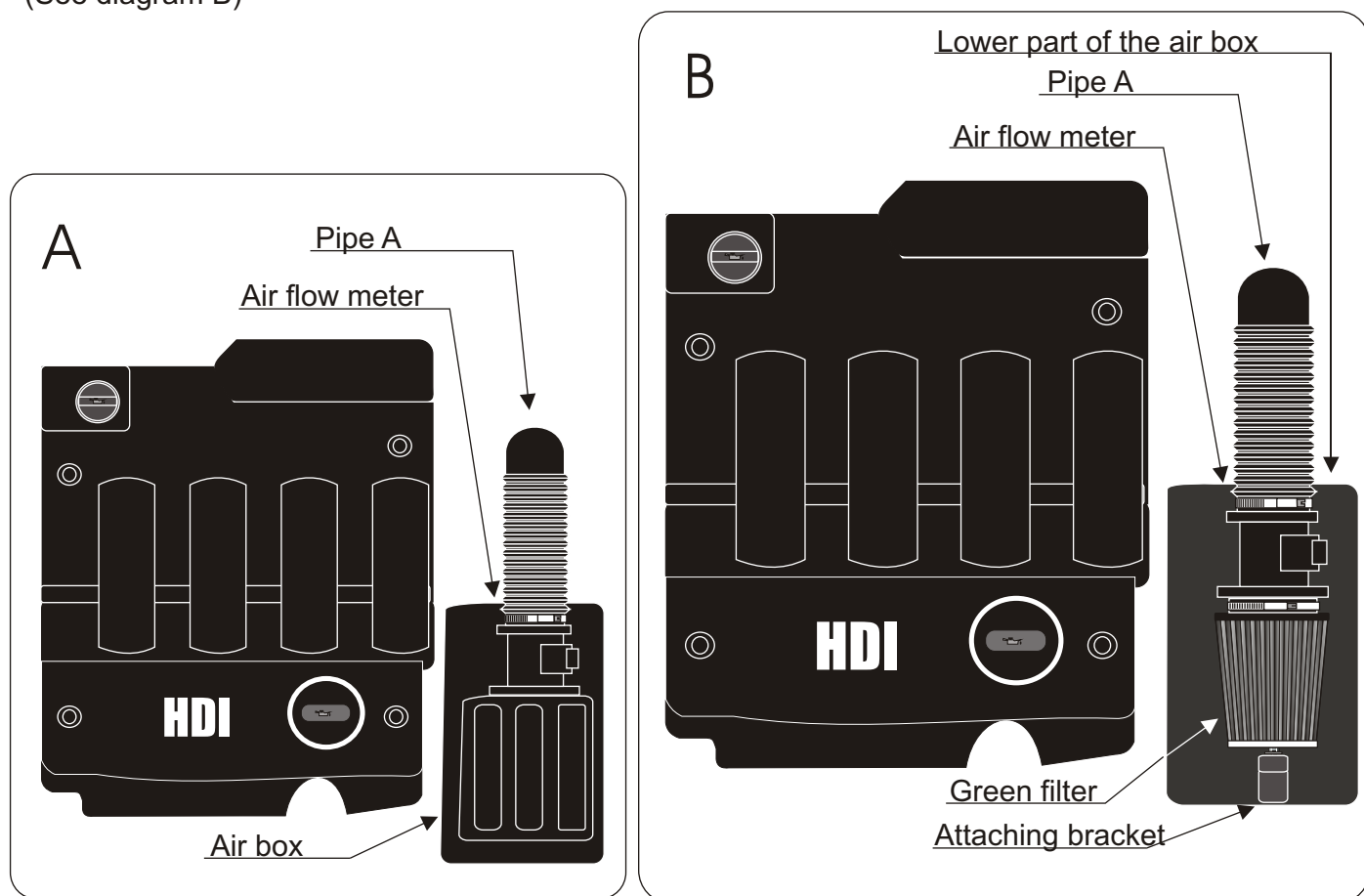

IMPORTANT:

The running of your engine is linked directly with the maintenance of the air filter. Clean your air filter every 7000 kms or 4500 miles with Green cleaning products.

WARRANTY:

The air filter guarantee is for defects in materials and workmanship only. Guarantee is void if the air filter is damaged by an accident, unreasonable use, neglect, misuse, abuse, improper installation or other causes not arising out of defects in materials and workmanship. The induction kit is a technical product so it is necessary to have some basic mechanical skills. If problems do not hesitate to have your induction kit fitted by a professional.

Green Technical dept : TEL: 00.33.3.44.02.64.64